

# Marine Starter Unit

## Denso, Hitachi & Mitsuba



**Metro Auto Industrial Inc.**

**Toll Free: 800-263-8761**

**[info@metroautoinc.com](mailto:info@metroautoinc.com)**

# Contents

**Denso**

**page 6**

**Hitachi**

**page 4**

**Mitsuba**

**page 5**

**Index-OE**

**page 18**

**Index-Lester**

**page 19**

This is  
Blank Page

# Hitachi Unit



**18493**

**12V, 2.0kw, CW, 9-Tooth**

**Hitachi OSGR**

**For:** High Performance Racing

**Engine:** Buick, Chevy, Oldsmobile, Pontiac

**OE:** PP106

**Lester:** 18493

**PIC:** 104-010

**Note:** Rotatable Front Housing.  
Aluminum Alloy DE Housing.

# Mitsuba Replacement

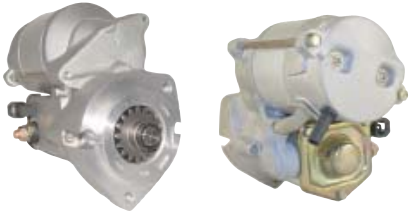

**18423\***

**12V, 1.2kw, 1.4kw, CCW, 17-Tooth  
Mitsuba OSGR, Silver Type**

**For:** Coleman Generator

**Engine:** Honda

**OE:** SM302-26, SM442-15

**Lester:** 18423

**PIC:** 191-300, 191-300A

**Note:** \*This is Denso OSGR replacement unit.

# Denso Unit



**18018**  
12V, 4.0kw, CW, 11-Tooth  
Denso OSGR, Heavy Duty

**For:** John Deere  
**Engine:** John Deere  
**OE:** 228000-653  
**Lester:** 18018

**PIC:** 190-890, 190-890A, 190-6057A  
**Note:**



**17362A**  
12V, 2.5kw, CW, 13-Tooth  
Denso OSGR, Heavy Duty

**For:** John Deere  
**Engine:** John Deere  
**OE:** 228000-647  
**Lester:** 17362A

**PIC:** 190-9006  
**Note:** For 11T version, please use 17362N.  
13T can replace to 11T.  
Also can replace to Bosch DD (Lester 17095), Delco DD (Lester 4000).

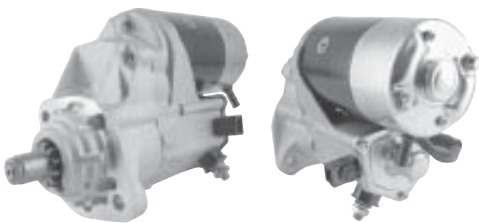

**17362**  
12V, 2.5kw, CW, 11-Tooth  
Denso OSGR, Heavy Duty

**For:** John Deere  
**Engine:** John Deere  
**OE:** 028000-840  
**Lester:** 17362

**PIC:** 190-830, 190-830A  
**Note:** For 13T version, please use 17362N-1.  
Also can replace to Bosch DD (Lester 17095), Delco DD (Lester 4000).



**18148**  
12V, 1.4kw, CW, 9-Tooth  
Denso OSGR, Silver Type

**For:** Kubota  
**Engine:** Cummins, Kubota  
**OE:** 028000-614, 128000-490, 228000-106  
**Lester:** 17027, 17606, 18148

**PIC:** 190-556, 190-575, 190-587  
**Note:**

# Denso Unit



**18197**  
12V, 2.5kw, CW, 12-Tooth  
Denso OSGR, Heavy Duty

**For:** Yanmar  
**Engine:** Yanmar  
**OE:** 128000-864, 228000-161  
**Lester:** 18197, 18424

**PIC:** 190-519, 190-769  
**Note:**

**Photo  
Coming Soon**

**16650**  
12V, 1.4kw, CW, 9-Tooth  
Denso OSGR, Waffle Type

**For:** Kubota  
**Engine:** Kubota  
**OE:** 028000-499, 028000-624, 028000-626,  
128000-017

**Lester:** 16650

**PIC:** 190-301, 190-301A, 190-301B, 190-301C, 190-306, 190-310, 190-374A, 190-374B, 190-374E

**Note:** 16645, 16650, 17368, 18144 interchangeable.

**Photo  
Coming Soon**

**16645**  
12V, 1.4kw, CW, 9-Tooth  
Denso OSGR, Gold Case

**For:** Kubota  
**Engine:** Kubota  
**OE:** 028000-420  
**Lester:** 16645

**PIC:** 190-301, 190-301A, 190-301B, 190-301C, 190-306, 190-310, 190-374A, 190-374B, 190-374E

**Note:** 16645, 16650, 17368, 18144 interchangeable.



**18144**  
12V, 1.4kw, CW, 9-Tooth  
Denso OSGR, Silver Type

**For:** Kubota  
**Engine:** Kubota  
**OE:** 228000-102, 228000-108, 228000-492  
**Lester:** 18144

**PIC:** 190-301, 190-301A, 190-301B, 190-301C, 190-306, 190-310, 190-374A, 190-374B, 190-374E

**Note:** 16645, 16650, 17368, 18144 interchangeable.

# Denso Unit

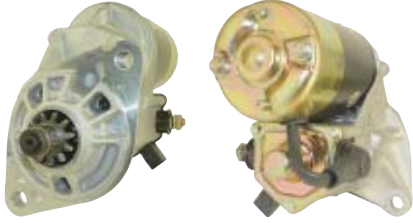

**17292**  
12V, 2.5kw, CW, 11-Tooth  
Denso OSGR, Heavy Duty

**For:** Hino, Mercury  
**Engine:**  
**OE:** 028000-977, 128000-509, 128000-530  
**Lester:** 17292

**PIC:** 190-840, 190-840A, 190-840B  
**Note:**



**18566**  
12V, 4.8kw, CW, 11-Tooth  
Denso OSGR, Heavy Duty

**For:** Hino, Hohn deere, Mercury  
**Engine:**  
**OE:** 228000-808

**Lester:** 18566

**PIC:** 190-758

**Note:** This is to replace the Denso DD, 12V, 4.0kw. (Lester 16635, 17618, 18177, 18272).



**17615**  
12V, 1.4kw, CW, 9-Tooth  
Denso OSGR, Gold Case

**For:** Catepillar  
**Engine:**  
**OE:** 128000-572  
**Lester:** 17615

**PIC:** 190-811  
**Note:**

**Photo  
Coming Soon**

**17115**  
12V, 1.4kw, CW, 11-Tooth  
Denso OSGR, Gold Case

**For:** Kubota  
**Engine:** Cummins  
**OE:** 028000-625  
**Lester:** 17115

**PIC:** 190-307

**Note:** 17115, 17116, 17367, 17619, 18175 interchangeable.



# Denso Unit

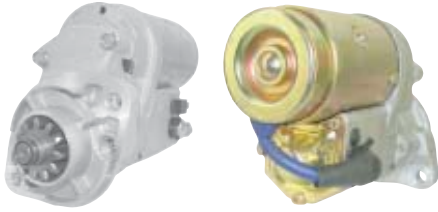

**17116**  
12V, 1.4kw, CW, 11-Tooth  
Denso OSGR, Gold Case

**For:** Kubota  
**Engine:** Cummins  
**OE:** 028000-783  
**Lester:** 17116

**PIC:** 190-302  
**Note:** 17115, 17116, 17367, 17619, 18175  
interchangeable.

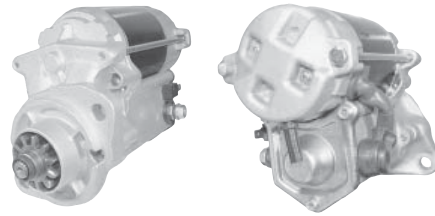

**17619**  
12V, 4.8kw, CW, 11-Tooth  
Denso OSGR, Waffle Type

**For:** Kubota  
**Engine:** Cummins  
**OE:** 128000-628

**Lester:** 17619

**PIC:** 190-318  
**Note:** 17115, 17116, 17367, 17619, 18175  
interchangeable.

**Photo  
Coming Soon**

**17367**  
12V, 1.4kw, CW, 11-Tooth  
Denso OSGR,

**For:** Kubota  
**Engine:** Cummins  
**OE:** 128000-014  
**Lester:** 17367

**PIC:** 190-313  
**Note:** 17115, 17116, 17367, 17619, 18175  
interchangeable.

**Photo  
Coming Soon**

**18175**  
12V, 1.4kw, CW, 11-Tooth  
Denso OSGR, Silver Type

**For:** Kubota  
**Engine:** Cummins  
**OE:** 228000-107  
**Lester:** 18175

**PIC:** 190-317  
**Note:** 17115, 17116, 17367, 17619, 18175  
interchangeable.

# Denso Unit



**17028**  
12V, 1.0kw, CW, 9-Tooth  
Denso OSGR, Steel Back

**For:** Kubota  
**Engine:** Kubota  
**OE:** 028000-832, 128000-359, 128000-995,  
228000-079  
**Lester:** 17028

**PIC:** 190-316, 190-316A, 190-316B, 190-316C

**Note:** 17028, 17098, 17606, 18019, 18419 interchangeable.



**17098**  
12V, 1.2kw/1.4kw CW, 9-Tooth  
Denso OSGR, WaffleType

**For:** Kubota  
**Engine:** Kubota  
**OE:** 128000-005, 128000-905, 228000-097,  
228000-099, 228000-366, 228000-905  
**Lester:** 17098

**PIC:** 190-432, 190-560, 190-560A, 190-560B

**Note:** 17028, 17098, 17606, 18019, 18419 interchangeable.



**18419**  
12V, 1.4kw, CW, 13-Tooth  
Denso OSGR, Silver Type

**For:** Kubota  
**Engine:** Kubota  
**OE:** 228000-632, 428000-264, 428000-540  
**Lester:** 18419

**PIC:** 190-6128, 190-6128A, 190-6128B

**Note:** 17028, 17098, 17606, 18019, 18419 interchangeable.

**Photo  
Coming Soon**

**17606**  
12V, 1.4kw, CW, 9-Tooth  
Denso OSGR, Waffle Type

**For:** Kubota  
**Engine:** Kubota  
**OE:** 128000-490  
**Lester:** 17606

**PIC:** 190-575

**Note:** 17028, 17098, 17606, 18019, 18419 interchangeable.

# Denso Unit



**18019**  
12V, 1.4kw, CW, 9-Tooth  
Denso OSGR, Silver Type

**For:** Kubota  
**Engine:** Kubota  
**OE:** 228000-015  
**Lester:** 18019

**PIC:** 190-583  
**Note:** 17028, 17098, 17606, 18019, 18419  
interchangeable.

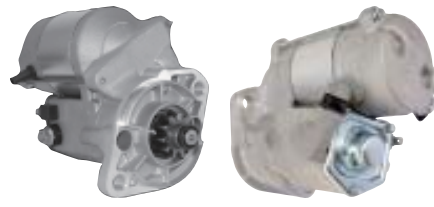

**18142**  
12V, 1.4kw CW, 11-Tooth  
Denso OSGR, Silver Type

**For:** Kubota  
**Engine:** Kubota  
**OE:** 228000-100  
**Lester:** 18142

**PIC:** 190-578  
**Note:** 18141, 18142, 18149 interchangeable.

**Photo  
Coming Soon**

**18141**  
12V, 1.4kw, CW, 11-Tooth  
Denso OSGR, Silver Type

**For:** Kubota  
**Engine:** Kubota  
**OE:** 228000-104  
**Lester:** 18141

**PIC:** 190-296  
**Note:** 18141, 18142, 18149 interchangeable.

**Photo  
Coming Soon**

**18149**  
12V, 1.4kw, CW, 11-Tooth  
Denso OSGR, Gold Case

**For:** Kubota  
**Engine:** Kubota  
**OE:** 128000-147  
**Lester:** 18149

**PIC:** 190-307A  
**Note:** 18141, 18142, 18149 interchangeable.

# Denso Unit

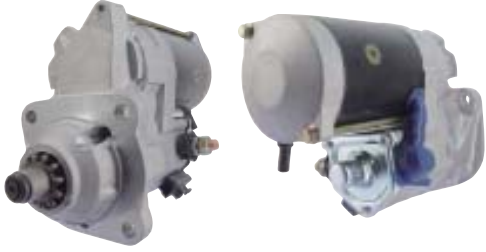

**18455**  
12V, 4.8kw, CW, 11-Tooth  
Denso OSGR, Heavy Duty

**For:** John Deere  
**Engine:** John Deere  
**OE:** 228000-655  
**Lester:** 18455

**PIC:** 190-785  
**Note:** M12 Battery Post

**Photo  
Coming Soon**

**18204N-ND\***  
12V, 2.5kw CW, 15-Tooth  
Denso OSGR, Heavy Duty

**For:** John Deere, Yanmar  
**Engine:** John Deere, Yanmar  
**OE:** S13-41, S13-41A, S13-41B, S13-41C,  
S13-41D, S13-78  
**Lester:** 18204

**PIC:** 104-291, 104-291A  
**Note:** \*This is to replace to Hitachi OSGR  
12V, 2.5kw (Lester 18204).

**Photo  
Coming Soon**

**18178**  
12V, 2.0kw, CW, 15-Tooth  
Denso OSGR, Gold Case

**For:** John Deere, Yanmar  
**Engine:** John Deere, Yanmar  
**OE:** 128000-730, 228000-711  
**Lester:** 18178

**PIC:** 190-505B, 190-505C  
**Note:**



**18019**  
12V, 1.4kw, CW, 9-Tooth  
Denso OSGR, Silver Type

**For:** Kubota  
**Engine:** Kubota  
**OE:** 228000-015, 228000-153  
**Lester:** 18019

**PIC:** 190-583

**Note:** 18019, 18400 interchangeable.

# Denso Unit



**18400**  
12V, 1.2kw/1.4kw, CW, 9-Tooth  
Denso OSGR, Silver Type

**For:** Kubota  
**Engine:** Kubota  
**OE:** 228000-095, 228000-098  
**Lester:** 18400

**PIC:** 190-429, 190-6106  
**Note:** 18019, 18400 interchangeable.



**17630**  
12V, 2.5kw CW, 10-Tooth  
Denso OSGR, Heavy Duty

**For:** John Deere  
**Engine:** John Deere  
**OE:** 128000-829, 428000-216  
**Lester:** 17630

**PIC:** 190-806  
**Note:** 17399, 17630 interchangeable.



**17399**  
12V, 2.5kw, CW, 10-Tooth  
Denso OSGR, Heavy Duty

**For:** John Deere  
**Engine:** John Deere  
**OE:** 128000-408, 228000-360, 428000-289  
**Lester:** 17399

**PIC:** 190-804, 190-804A, 190-804B  
**Note:** 17399, 17630 interchangeable.

**Photo  
Coming Soon**

**18326N-ND\***  
12V, 2.5kw, CW, 11-Tooth  
Denso OSGR, Heavy Duty

**For:** Yanmar  
**Engine:** Yanmar  
**OE:** S13-68, S13-68A, S13-68C, S13-86  
**Lester:** 18326

**PIC:** 140-248, 140-262  
**Note:** \*This is to replace Hitachi OSGR, 12V,  
2.5kw (Lester 18326).

# Denso Unit

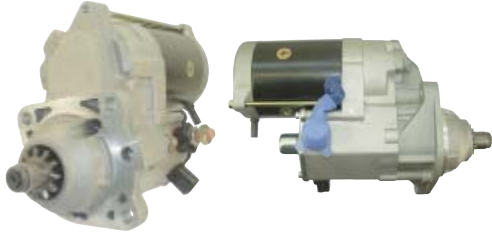

**18458**  
24V, 7.8kw, CW, 11-Tooth  
Denso OSGR, Heavy Duty

**For:** John Deere Marine  
**Engine:** John Deere  
**OE:** 228000-701  
**Lester:** 18458

**PIC:** 190-6055  
**Note:**



**18560\***  
12V, 2.7kw CW, 10-Tooth  
Denso OSGR, Heavy Duty

**For:** Hyster, International Harvester, Nikko,  
Nikko Denki, also for Marine.  
**Engine:**  
**OE:** 228000-640  
**Lester:** 18560, 4196\*, 4274\*, 4569\*, 4963\*,  
6576\*

**PIC:** 140-853D\*, 140-853E\*, 140-853\*, 140-  
853A\*, 140-853F\*, 140-853J\*, 140-  
**Note:** 924\*

\*Also can replace to Nikko OSGR  
28MT (Lester 4196, 4274, 4569, 4963,  
6576).



**19104**  
12V, 2.7kw, CW, 10-Tooth  
Denso OSGR, Heavy Duty

**For:** Marine Application  
**Engine:** Cummins  
**OE:** 428000-292  
**Lester:** 19104

**PIC:** ]190-6225  
**Note:**

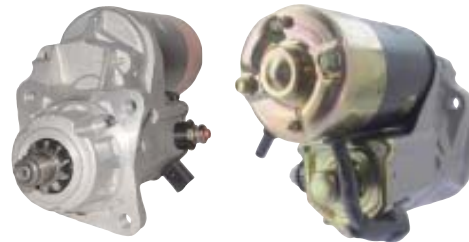

**17388\***  
12V, 2.5kw, CW, 10-Tooth  
Denso OSGR, Heavy Duty

**For:** John Deere, Nikko, Nikko Denki, West-  
erbeke  
**Engine:**  
**OE:** 128000-704  
**Lester:** 17388, 6166\*, 6572\*

**PIC:** 190-792, 140-846\*, 140-846A\*, 140-  
925\*

**Note:** \*Also can replace to Nikko OSGR  
28MT (Lester 6166, 6572).

# Denso Unit

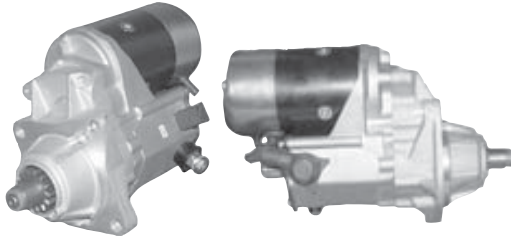

**16658**  
**12V, 2.5kw, CW, 10-Tooth**  
**Denso OSGR, Heavy Duty**

**For:** Ford, Mercury Marine  
**Engine:** Cummins  
**OE:** 028000-588  
**Lester:** 16658, 3300\*, 4391\*, 6573\*

**PIC:** 190-800

**Note:** \*Also can replace to Nikko OSGR (Lester 3300, 4391, 6573).  
 There is two type Denso can replace it:  
 16658 (12V, 2.5kw)  
 17818 (12V, 4.0kw)

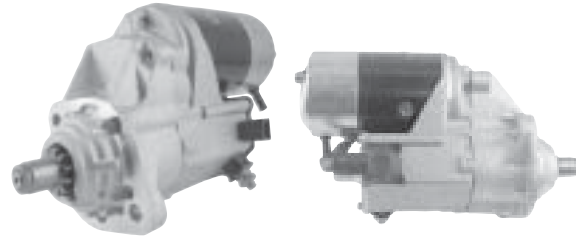

**17362**  
**12V, 2.5kw CW, 11-Tooth**  
**Denso OSGR, Heavy Duty**

**For:** John Deere, Kubota, Nikko, Nikko  
 Denki  
**Engine:**  
**OE:** 028000-840  
**Lester:** 17362

**PIC:** 190-830, 190-830A

**Note:** Also can replace to Denso DD (Lester 17334).  
 Also can replace to Nikko OSGR (Lester 4000, 4960, 6570).

**Photo  
 Coming Soon**

**17818**  
**12V, 4.0kw, CW, 10-Tooth**  
**Denso OSGR, Heavy Duty**

**For:** Ford, Mercury Marine  
**Engine:** Cummins  
**OE:** 228000-841  
**Lester:** 17818, 3300\*, 4391\*, 6573\*

**PIC:** 190-838

**Note:** \*Also can replace to Nikko OSGR (Lester 3300, 4391, 6573).  
 There is two type Denso can replace it:  
 16658 (12V, 2.5kw)  
 17818 (12V, 4.0kw)



**17362A**  
**12V, 2.5kw, CW, 13-Tooth**  
**Denso OSGR, Heavy Duty**

**For:** John Deere, Kubota, Nikko, Nikko  
 Denki  
**Engine:**  
**OE:** 228000-647  
**Lester:** 17362A

**PIC:** 190-9006

**Note:** Also can replace to Denso DD (Lester 17334).  
 Also can replace to Nikko OSGR (Lester 4000, 4960, 6570).

# Denso Unit

**Photo  
Coming Soon**

**18274**  
**12V, 1.8kw, CW, 11-Tooth**  
**Denso OSGR, Silver Type**

**For:** Nikko, Nikko Denki  
**Engine:**  
**OE:** 228000-844  
**Lester:** 18274

**PIC:** 190-754, 140-931\*  
**Note:** \*Also can replace to Nikko 28MT  
OSGR (Lester 6586).



Manufacturers and Supplier names and their part numbers are for reference use only.

# Index-OE

Denso	
<i>OE</i>	<i>page</i>
028000-420	7
028000-499	7
028000-588	15
028000-614	6
028000-624	7
028000-625	8
028000-626	7
028000-783	9
028000-832	10
028000-840	6, 15
028000-977	8
128000-005	10
128000-014	9
128000-017	7
128000-147	11
128000-359	10
128000-408	13
128000-490	6, 10
128000-509	8
128000-530	8
128000-572	8
128000-628	9
128000-704	12
128000-730	12
128000-829	13
128000-864	7
128000-905	10
128000-995	10
228000-015	11, 12
228000-079	10
228000-095	13
228000-097	10
228000-098	12
228000-099	10
228000-100	11
228000-102	7
228000-104	11
228000-106	6
228000-107	9
228000-108	7
228000-153	12
228000-161	7
228000-360	13
228000-366	10
228000-492	7
228000-632	10
228000-640	14
228000-647	6, 15
228000-653	6
228000-655	12
228000-701	14
228000-711	12
228000-808	8
228000-841	15
228000-844	16
228000-905	10
428000-216	13
428000-264	10
428000-289	12

Denso	
<i>OE</i>	<i>page</i>
428000-292	14
428000-540	10

Hitachi	
<i>OE</i>	<i>page</i>
PP106	4
S13-41	12
S13-41A	12
S13-41B	12
S13-41C	12
S13-41D	12
S13-68	13
S13-68A	13
S13-68C	13
S13-78	12
S13-86	13

Mitsuba	
<i>OE</i>	<i>page</i>
SM302-26	5
SM442-15	5

# Index-Lester

Lester	
<i>Lester</i>	<i>page</i>
3300	15
4196	14
4274	14
4391	15
4569	14
4963	14
6166	14
6572	14
6573	15
6576	14
6586	16
16645	7
16650	7
16658	15
17027	6
17028	10
17098	10
17115	8
17116	9
17292	8
17362	6, 15
17362A	6, 15
17367	9
17388	14
17399	13
17606	6, 10
17615	8
17619	9
17630	13
17818	15
18018	6
18019	11, 12
18141	11
18142	11
18144	7
18148	6
18149	11
18175	9
18178	12
18197	7
18204	12
18274	16
18326	13
18400	13
18419	10
18423	5
18424	7
18455	12
18458	14
18493	4
18560	14
18566	8
19104	14

Lester	
<i>Lester</i>	<i>page</i>

Lester	
<i>Lester</i>	<i>page</i>



# Metro Auto Industrial Inc.

2128 Pomona Boulevard . Pomona . CA 91768-3332

Phone:(909)629-2700 . Fax:(909)629-2721

**Toll Free:1-800-263-8761**

**Toll Free Fax:1-800-799-0838**

[www.metroautoinc.com](http://www.metroautoinc.com)

[info@metroautoinc.com](mailto:info@metroautoinc.com)

Care is taken to ensure the accuracy of photo, descriptions and applications of each items,  
but Metro Auto Industrial Inc. assumes no responsibility for possible errors.

All the OE number and Lester number are for referece use only.